

Please read the instructions for the installation and handling of your 3P Leaf Separator rainwater filter carefully and follow the advice.

Handling and installation advice for the 3P Leaf Separator

Thank you for deciding to buy our product.
The 3P Leaf Separator is designed for:

- **Continuous separation of dirt from the downpipe at an easy accessible place.**
- **Thereby: No overflowing gutters due to blocked downpipes.**
- **No maintenance required at unsafe or dizzying heights.**

To fulfil our duty of care we draw your attention to the following advice for safe handling of the 3P Leaf Separator

- Only connect to a roof area with 45° gradient of the roof and max. 80m².
- Always remember: with unfavourable weather conditions the efficient working of the 3P Leaf Separator can be reduced e.g. through freezing. With frost, hail and extreme participation we recommend switching off the 3P Leaf Separator.
- If any integrated downpipe lightning protection equipment installed before the installation of the 3P Leaf Separator is bridged by the 3P Leaf Separator it has to be reinstalled by a lightning contractor (consult an expert contractor).
- Check regularly that the filter is working (withdraw the sieve cartridge and look inside the housing).

1. Technical data



Leaf Separator

Supplied with optional rubber grommet that is installed in the top of the separator when the downpipe outer diameter is 85mm or less.

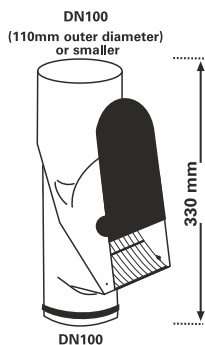

Reduction adapter

Lower adapter for:

- 68 to 100mm round downpipes
- 65 to 78mm square downpipes

Note: for 110mm round downpipes the lower adaptor is not required.

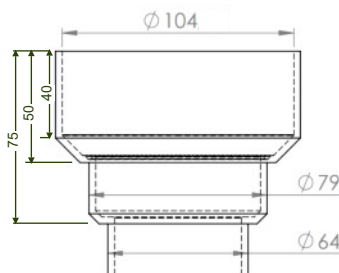

All measurements in mm +/- 1mm

2. How it works

- 1 Coarse dirt is filtered out of the rainwater through the filter.
- 2 Leaves and coarse dirt are ejected to the outside.
- 3 Cleaned rainwater flows on down the down pipe.

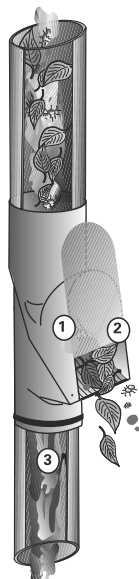

3. Installation Instructions

General advice:

Always install the filter in Vertical downpipes.

Installation:

Remove a section of downpipe corresponding to the measurement, as shown in the diagram. The 3P Leaf Separator is designed so that the downpipe slots into the top of the unit by about 20mm. This overlap distance is not critical as long as the downpipe hangs below the upper edge of the 3P Leaf Separator

You need to make horizontal cuts and then to file the cut surfaces smooth.

1. Cut a section of downpipe out

Separate the downpipe with 2 horizontal sawing cuts and remove the middle piece.

Attention: cut exactly!

2. Insert the 3P Leaf Separator

The upper downpipe section can either be carefully pushed to the side or lifted up a bit. Then push the 3P Leaf Separator on to the end of the downpipe as shown in the diagram.

3. Place the 3P Leaf Separator Using the reduction adapter

Insert the reducer piece into the lower downpipe*. Push the rubber grommet into the top of the 3P Leaf Separator. Push the lower connection piece of the 3P Leaf Separator into the lower downpipe.

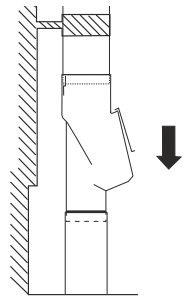
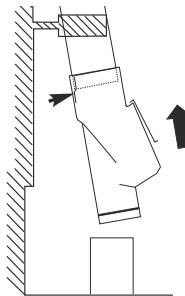
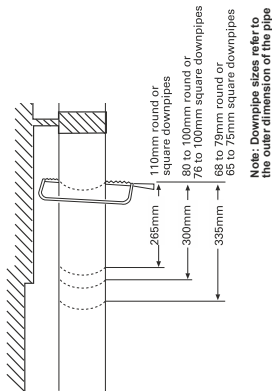

* It may be necessary to trial fit the adaptor to the 3P Leaf Separator as it is a tight fit. The front and back lower connection flanges of the 3P Leaf Separator can be gently folded to ease the installation.

4. Winter Operation

Before period of heavy and prolonged frosts. In particular when daytime temperatures are at or below around -5°C and there is a risk of thaw water re-freezing in the filter body.

1. Remove Sieve Unit

With the aid of a screwdriver or similarly shaped tool, gently tease out the filter near the lower filter connection points on the Leaf Separator to remove the filter part. Store safely for the frost period.

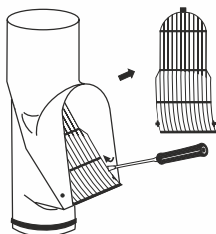

2. Close Filter Lid

Position lid above opening and slide down into position. This prevents air entering the downpipe and the re-freezing of any melt water from the roof.



3. Reinstalling Filter Sieve.

Return the lid to the open position. Reposition the sieve unit in the housing. Follow diagrams, as shown. Click the upper sieve lug into position between the two tabs, before snapping the lower end side plugs into position.

